

INSTALLATION FOR FLH4 HIGH WATTAGE FLOOD SERIES



SAVE THESE INSTRUCTIONS - READ ALL INSTRUCTIONS CAREFULLY

INTRODUCTION

- This LED Flood light uses the latest in solid state lighting technology for long life, low maintenance and high efficiency.
- The same as traditional HID lighting, there are 2 installation methods suitable for various applications.
- 120-277V An internal power factor corrected switch mode supply allows for use from any nominal 120-277V, 60Hz AC supply without any variation in light output.
- 347V An internal power factor corrected switch mode supply allows for use in any nominal 277-480V, 50-60Hz AC supply without any variation in light output.
- Suitable for use in ambient temperatures from -40°C to +40°C
- Suitable for use in wet locations - IP65.



⚠ WARNING

PLEASE READ ALL INSTRUCTIONS BEFORE ATTEMPTING INSTALLATION.

- To avoid the risk of fire, explosion, or electrical shock, this product should be installed, inspected and maintained by a qualified electrician only, in accordance with all national and regional electrical codes.
- To avoid electrical shock, be certain that the power is OFF before and during installation and maintenance.
- Luminaire must be connected to a wiring system with an equipment grounding conductor.
- To avoid explosion, make sure that the supply voltage is the same as the rated luminaire voltage.
- Do not install where the marked operating temperatures exceed the ignition temperatures of a hazardous application.
- Do not operate in ambient temperatures above those rated by the luminaire.
- Keep lens tightly closed when in operation.
- For supply connections, use wire rated for at least 90°C.

INSTALLATION STEPS

- Refer to the following diagram when you install the fixture. There are several installation

- FLH4-150U50-BL-TR
- FLH4-150350-BL-TR
- FLH4-220U50-BL-TR
- FLH4-220350-BL-TR
- FLH4-300U50-BL-TR
- FLH4-300350-BL-TR
- FLH4-380U50-BL-TR
- FLH4-380350-BL-TR

TRUNNION MOUNT DIMENSIONS

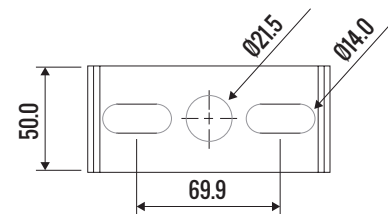

DIRECTLY FIX TO MOUNTING SURFACE - TRUNNION MOUNT

1. Use Expansion bolts to secure the fixture on the mounting surface.
2. Keep enough wire length to ensure adjusting angle is unhindered.

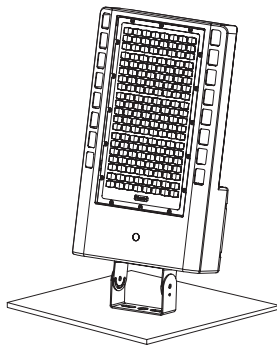

MOUNTING WITH A SLIPFITTER FOR MODELS

1. Trunnion mount removed on following fixtures and square slipfitter - FLH4 SSF-150/220/300 - installed - FLH4-150U50-BL-TR / FLH4-150350-BL-TR / FLH4-220U50-BL-TR / FLH4-220350-BL-TR / FLH4-300U50-BL-TR / FLH4-300350-BL-TR.
2. Models that come with round slipfitter already installed - FLH4-380U50-BL-RSF / FLH4-380350-BL-RSF

STEP 1

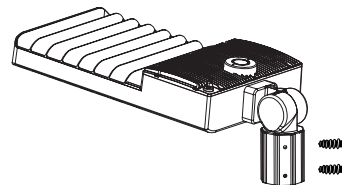

Adjust the fixture orientation by turning the bolt. In the above photo for the rocker installation hole, for the sensor installation hole in the bottom

STEP 2

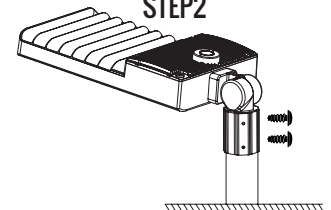

Please use a post of diameter 2.36" for mounting, and tighten with screws. You can open the side cover from the side connection

*Connect wires into wiring terminal - white wire to "Neutral" terminal / black wire to "live" terminal / green wire to "ground" terminal - fix with wire nuts.

INSTALLATION FOR FLH4 HIGH WATTAGE FLOOD SERIES

SAVE THESE INSTRUCTIONS - READ ALL INSTRUCTIONS CAREFULLY



MOUNTING WITH A TRUNNION MOUNT FOR MODELS

FLH4-150U50-BL-TR / FLH4-150350-BL-TR / FLH4-220U50-BL-TR / FLH4-300U50-BL-TR
/ FLH4-300350-BL-TR / FLH4-380U50-BL-TR / FLH4-380350-BL-TR

STEP 1

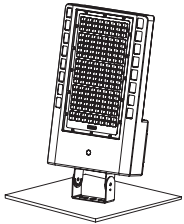

Please drill the holes on the square pole according to the size above

STEP 2

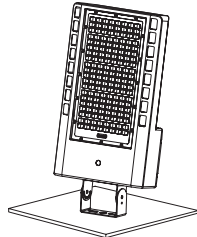

Adjust the fixture to an apposite orientation, tighten the screws

MOUNTING WITH A SLIPFITTER FOR MODELS

- * Trunnion mount removed from following fixtures and extruded arm - FLH4-EX - installed - FLH4-150U50-300350-BL-TR.
- * Trunnion mount removed from following fixtures and extruded arm - FLH4-EX-380 - installed - FLH4-EX-380U50-BL-TR / FLH4-380350-BL-TR.

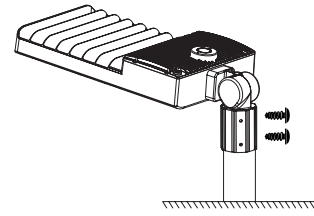

Directly with the screw on the lamp post. In the above straight arm has a reserved light installation hole, for the sensor installation hole in the bottom. You can open the side cover from the side connection.

*Connect wires into wiring terminal - white wire to "Neutral" terminal / black wire to "live" terminal / green wire to "ground" terminal - fix with wire nuts.

⚠ IMPORTANT

- AFTER INSTALLATION, ENSURE THE FIXTURE IS FIRMLY INSTALLED TO THE MOUNTING SURFACE OR POLE. VERIFY THAT ALL WIRES ARE PROPERLY CONNECTED AND SHIELDED.
- TURN ON POWER TO VERIFY ALL CONNECTIONS WERE PROPERLY MADE..

DIMMING

- SAFETY INFORMATION - Incorrect wiring will damage this product. All wires are strictly prohibited to opposite polarity and shortcut. The dimming wires of the dimmable driver are strictly prohibited to connect to voltage higher than 24V.
- In order to avoid that bare wires contact a metal part or higher voltage source, the dimming wires must be isolated by code method when the dimming function is not used - wrapped by tape or sealed in a wire nut.

FIXTURE TYPE	VOLTAGE	0-5V DIM	0-10V DIM	PWV DIM	TIME DIM
FLH4-150U50-BL-TR	120 - 277V	YES	YES	YES	YES
FLH4-150350-BL-TR	347V	NO	YES	YES	YES
FLH4-220U50-BL-TR	120 - 277V	YES	YES	YES	YES
FLH4-220350-BL-TR	347V	NO	YES	YES	YES
FLH4-300U50-BL-TR	120 - 277V	NO	YES	NO	YES
FLH4-300350-BL-TR	347V	NO	YES	YES	YES
FLH4-380U50-BL-TR	120 - 277V	YES	YES	YES	YES
FLH4-380350-BL-TR	347V	NO	YES	YES	YES